

Distance in Meters				
	Head No	Head No	Head No	PEDS
	1	2	3	
Temporary Traffic Signal Timings				
RED	10	10	10	10
GREEN	35	35	35	10
Maximum RED Timings (Seconds)				
0-50m	50m-100m	100m-150m	150m-200m	200m-250m
5s	10s	15s	20s	25s
Length Of Works (Meters)				
Maximum GREEN Timings (Seconds)				
30m-75m	75m-135m	135m-195m	195m-300m	
35s	40s	45s	50s	

Please note that the settings of Maximum Green time should be increased if substantial queues begin to form  
The timings should not be reduced below the insital settings approved

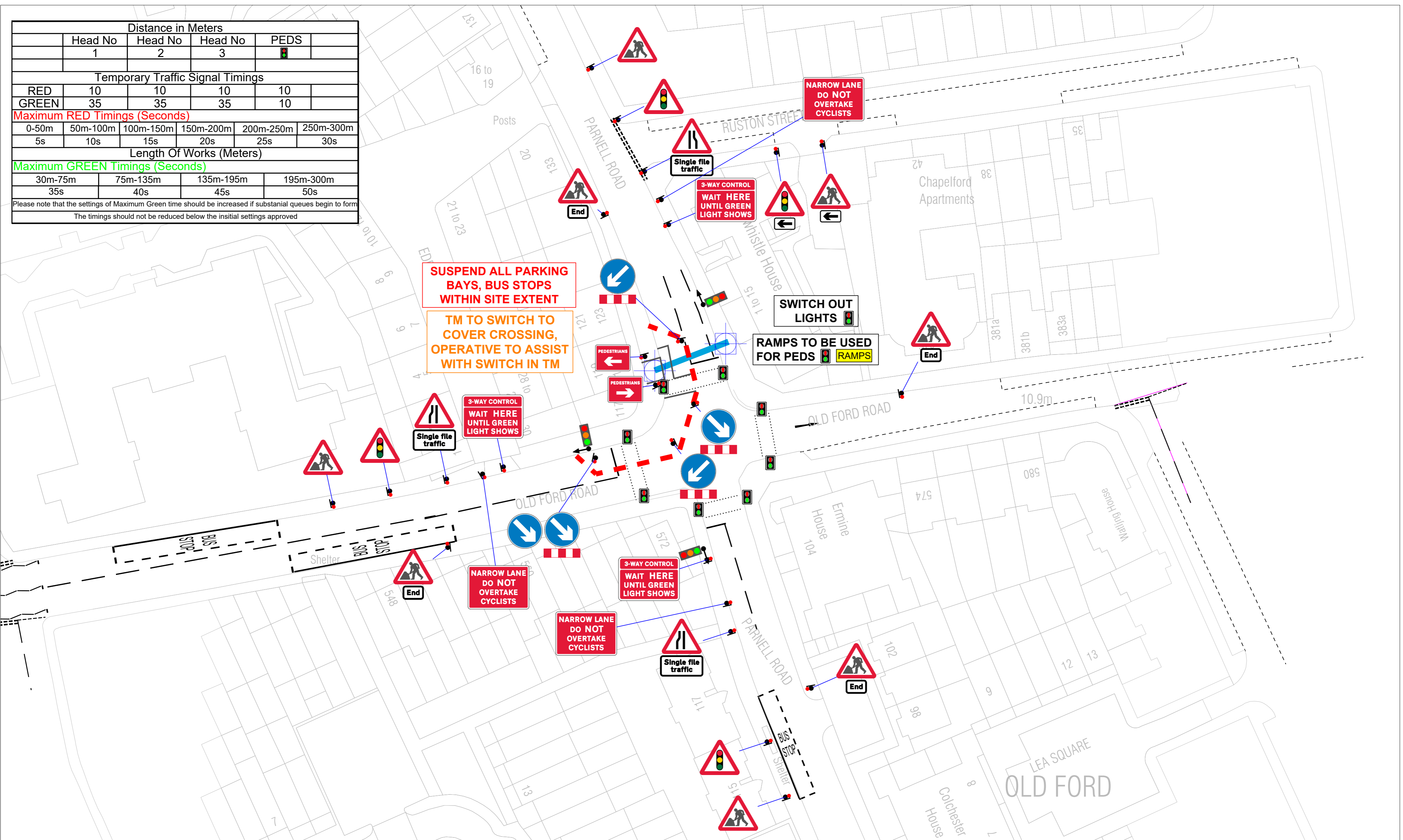

	Minimum Sideways safety zone 0.5M Min (S)
	Minimum longways safety zone 0.5M Min (L)

FREE PARKING WILL REQUIRE N.P.C BEFORE WORKS START AS AND WHEN REQUIRED

MAINTAIN RESIDENTS ACCESS AS REQUIRED AT ALL TIMES

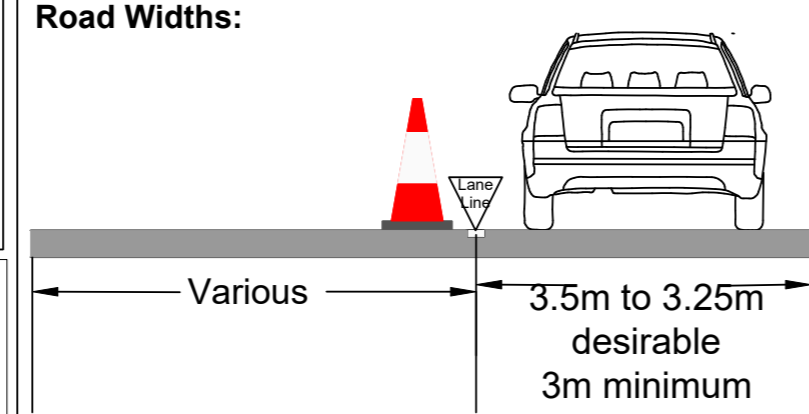

- NOTES:
1. All signs and cones to be in accordance with Chapter 8 new roads and street works a code of practice (Red book)
  2. Works access and egress are indicative, exact locations to be agreed on site.
  3. Safety zones are to be installed as required as shown by the SAFETY ZONE DIMENSIONS BELOW
  4. All signs to be located so as not to obscure signs or objects and should be ballasted near to ground level using sand filled hessian bags or sign straps.
  5. All sign positions are indicative only and must be accurately positioned on site with good visibility and be clear of and obstructions or vegetation at all times.
  6. Drawing not to scale

**PHASE 1**

Traffic Management: -  
**TRAFFIC LIGHTS**

Date Drawn: 08/09/2023  
Drawn By: A.W

TEMPSOL-DWG-242  
Parnell Road, Old Ford, Bow, London Borough of Tower Hamlets, E3 2JF,  
51.536269,-0.028187232

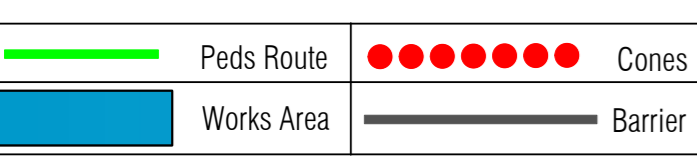

RAMPS TO BE USED FOR PEDS AS REQUIRED